

# Public Document Pack

## NOTICE OF MEETING

www.rbwm.gov.uk



## LICENSING PANEL SUB-COMMITTEE

will meet on

**WEDNESDAY, 30TH JANUARY, 2019**

**At 10.00 am**

in the

**ASCOT ROOM, GUILDHALL, WINDSOR**

TO: MEMBERS OF THE LICENSING PANEL SUB-COMMITTEE

COUNCILLORS MALCOLM ALEXANDER, PHILLIP BICKNELL AND DEREK WILSON

Karen Shepherd – Service Lead-Governance - Democratic Services – Issued: 22 January 2019

Members of the Press and Public are welcome to attend Part I of this meeting. The agenda is available on the Council's web site at [www.rbwm.gov.uk](http://www.rbwm.gov.uk) or contact the Panel Administrator **Shilpa Manek** 01628 796310

**Accessibility** - Members of the public wishing to attend this meeting are requested to notify the clerk in advance of any accessibility issues

**Fire Alarm** - In the event of the fire alarm sounding or other emergency, please leave the building quickly and calmly by the nearest exit. Do not stop to collect personal belongings and do not use the lifts. Do not re-enter the building until told to do so by a member of staff.

**Recording of Meetings** –In line with the council's commitment to transparency the public part of the meeting will be audio recorded, and may also be filmed and broadcast through the online application Periscope. If filmed, the footage will be available through the council's main Twitter feed @RBWM or via the Periscope website. The audio recording will also be made available on the RBWM website, after the meeting.

Filming, recording and photography of public Council meetings may be undertaken by any person attending the meeting. By entering the meeting room you are acknowledging that you may be audio or video recorded and that this recording will be in the public domain. If you have any questions regarding the council's policy, please speak to the Democratic Services or Legal representative at the meeting

## **AGENDA**

### **PART I**

<b><u>ITEM</u></b>	<b><u>SUBJECT</u></b>	<b><u>PAGE NO</u></b>
1.	<b><u>APPOINTMENT OF CHAIRMAN</u></b>  To appoint a Chairman for the duration of the meeting.	
2.	<b><u>APOLOGIES FOR ABSENCE</u></b>  To receive any apologies for absence.	
3.	<b><u>DECLARATIONS OF INTEREST</u></b>  To receive any declarations of interest.	5 – 6
4.	<b><u>PROCEDURES FOR LICENSING PANEL SUB COMMITTEE</u></b>  To note the procedural details for the hearing.	7 – 8
5.	<b><u>CONSIDERATION OF APPLICATION FOR A NEW PREMISES LICENCE UNDER THE LICENSING ACT 2003</u></b>  To consider an application for a new premises licence under The Licensing Act 2003 for Costcutters, 113-117 Springfield Road, Windsor, SL4 3PZ.	9 – 66



This page is intentionally left blank

## MEMBERS' GUIDE TO DECLARING INTERESTS IN MEETINGS

### Disclosure at Meetings

If a Member has not disclosed an interest in their Register of Interests, they **must make** the declaration of interest at the beginning of the meeting, or as soon as they are aware that they have a DPI or Prejudicial Interest. If a Member has already disclosed the interest in their Register of Interests they are still required to disclose this in the meeting if it relates to the matter being discussed.

A member with a DPI or Prejudicial Interest **may make representations at the start of the item but must not take part in the discussion or vote at a meeting.** The speaking time allocated for Members to make representations is at the discretion of the Chairman of the meeting. In order to avoid any accusations of taking part in the discussion or vote, after speaking, Members should move away from the panel table to a public area or, if they wish, leave the room. If the interest declared has not been entered on to a Members' Register of Interests, they must notify the Monitoring Officer in writing within the next 28 days following the meeting.

### Disclosable Pecuniary Interests (DPIs) (relating to the Member or their partner) include:

- Any employment, office, trade, profession or vocation carried on for profit or gain.
- Any payment or provision of any other financial benefit made in respect of any expenses occurred in carrying out member duties or election expenses.
- Any contract under which goods and services are to be provided/works to be executed which has not been fully discharged.
- Any beneficial interest in land within the area of the relevant authority.
- Any licence to occupy land in the area of the relevant authority for a month or longer.
- Any tenancy where the landlord is the relevant authority, and the tenant is a body in which the relevant person has a beneficial interest.
- Any beneficial interest in securities of a body where:
  - a) that body has a piece of business or land in the area of the relevant authority, and
  - b) either (i) the total nominal value of the securities exceeds £25,000 or one hundredth of the total issued share capital of that body **or** (ii) the total nominal value of the shares of any one class belonging to the relevant person exceeds one hundredth of the total issued share capital of that class.

Any Member who is unsure if their interest falls within any of the above legal definitions should seek advice from the Monitoring Officer in advance of the meeting.

A Member with a DPI should state in the meeting: ***'I declare a Disclosable Pecuniary Interest in item x because xxx. As soon as we come to that item, I will leave the room/ move to the public area for the entire duration of the discussion and not take part in the vote.'***

Or, if making representations on the item: ***'I declare a Disclosable Pecuniary Interest in item x because xxx. As soon as we come to that item, I will make representations, then I will leave the room/ move to the public area for the entire duration of the discussion and not take part in the vote.'***

### Prejudicial Interests

Any interest which a reasonable, fair minded and informed member of the public would reasonably believe is so significant that it harms or impairs the Member's ability to judge the public interest in the item, i.e. a Member's decision making is influenced by their interest so that they are not able to impartially consider relevant issues.

A Member with a Prejudicial interest should state in the meeting: ***'I declare a Prejudicial Interest in item x because xxx. As soon as we come to that item, I will leave the room/ move to the public area for the entire duration of the discussion and not take part in the vote.'***

Or, if making representations in the item: ***'I declare a Prejudicial Interest in item x because xxx. As soon as we come to that item, I will make representations, then I will leave the room/ move to the public area for the entire duration of the discussion and not take part in the vote.'***

### Personal interests

Any other connection or association which a member of the public may reasonably think may influence a Member when making a decision on council matters.

Members with a Personal Interest should state at the meeting: ***'I wish to declare a Personal Interest in item x because xxx'. As this is a Personal Interest only, I will take part in the discussion and vote on the matter.***

This page is intentionally left blank

## LICENSING SUB-COMMITTEE

### PROCEDURES

The Chairman will welcome all parties to the meeting, introduce the Sub-Committee Members and officers present, and outline the procedure as below:

- a) The Licensing Officer to outline the application and the decision to be taken
- b) Members to ask questions of the Licensing Officer
- c) The Applicant to put their case to the Sub-Committee and clarify any information arising from the Licensing Officer's outline
- d) Any Objectors to address the Sub-Committee and put their case
- e) Members to ask questions of the Objectors
- f) Applicant to ask questions of the Objectors
- g) Any party requested by the Applicant to address the Sub-Committee (at the Sub-Committee's discretion)
- h) Members to ask questions of the Applicant
- i) Objectors to ask questions of the Applicant
- j) Applicant to briefly summarise their position
- k) Objectors to briefly summarise their position
- l) Licensing Officer to provide a summary
- m) Chair to ask all parties if they have said all that they wish to
- n) Sub-Committee to retire for deliberations

**N.B. Decision letter to be sent to applicant within 5 working days**

This page is intentionally left blank



## REPORT TO LICENSING PANEL SUB COMMITTEE.

### CONSIDERATION OF APPLICATION FOR A NEW PREMISES LICENCE UNDER THE LICENSING ACT 2003

LICENSING PANEL SUB COMMITTEE: January 2019

OFFICER REPORTING: Steve Smith

#### A) The Application

Applicant: - Charul Patel

Premises: - Costcutter, 113-117 Springfield Road, Windsor, SL4 3 PZ

The application relates to an application for a new premises licence.

A summary of the application is as follows:-

The standard opening hours of the premises:

- 06.00 until 23.00 hrs Monday to Sunday

To permit the sale by retail of alcohol for consumption OFF the premises:

- 06.00 until 23.00 hrs Monday to Sunday

Designated Premises Supervisor (DPS): Charul Patel

This is a brand new application for a premises licence, the premises itself has not held a premises licence before, and to the best of our knowledge has been an electrical retail outlet for many years. The application has been made outside of the current framework hours within the RBWM licensing policy (this is detailed further within the report).

#### B) Relevant Representations

Responsible Authorities.

a. Environmental Health (CPES):	None
b. RBFRS (Fire Officer):	None
c. Planning Officer:	None
d. Local Safeguarding Children's Board (LSCB)	None
e. Public Health:	None
f. Trading Standards:	Attached
g. Thames Valley Police:	None
h. RBWM Licensing:	None

Trading Standards have requested a number of conditions relating to one of the four key objectives;- Prevention of children from harm - which is attached, however, these have been agreed by the applicant.

Interested Parties:

- 12 representations from local residents.
- Petition signed by 138 local residents.
- 02 representation from local ward Councilors.

**C) It is considered that the following policies have a bearing upon the application.**

### **182 National Guidance April 2018**

The sub committee must have regard to the amended Secretary of States guidance issued in April 2018 under Section 182 of the Licensing Act 2003 and in particular Chapters 9 (Determining applications) and 10 (Conditions attached to Premises Licences). Particular regard should be had to paragraphs 9.31 – 9.41 (Hearings) and 9.42 – 9.44 (Determining actions that are appropriate for the promotion of the licensing objectives).

Also the following relevant sections

#### Crime and Disorder

2.1 Licensing authorities should look to the police as the main source of advice on crime and disorder. They should also seek to involve the local Community Safety Partnership (CSP).

2.3 Conditions should be targeted on deterrence and preventing crime and disorder including the prevention of illegal working in premises (see paragraph 10.10). For example, where there is good reason to suppose that disorder may take place, the presence of closed-circuit television (CCTV) cameras both inside and immediately outside the premises can actively deter disorder, nuisance, anti-social behaviour and crime generally. Some licence holders may wish to have cameras on their premises for the prevention of crime directed against the business itself, its staff, or its customers. But any condition may require a broader approach, and it may be appropriate to ensure that the precise location of cameras is set out on plans to ensure that certain areas are properly covered and there is no subsequent dispute over the terms of the condition.

2.5 Conditions relating to the management competency of designated premises supervisors should not normally be attached to premises licences. It will normally be the responsibility of the premises licence holder as an employer, and not the licensing

authority, to ensure that the managers appointed at the premises are competent and appropriately trained. The designated premises supervisor is the key person who will usually be responsible for the day to day management of the premises by the premises licence holder, including the prevention of disorder. A condition of this kind may only be justified as appropriate in rare circumstances where it can be demonstrated that, in the circumstances associated with particular premises, poor management competency could give rise to issues of crime and disorder and public safety.

2.6 The prevention of crime includes the prevention of immigration crime including the prevention of illegal working in licensed premises. Licensing authorities should work with Home Office Immigration Enforcement, as well as the police, in respect of these matters. Licence conditions that are considered appropriate for the prevention of illegal working in the licensed premises might include requiring a premises licence holder to undertake right to work check on all staff employed at the licensed premises or requiring that a copy of any documents checked as part of a right to work check are retained at the licensed premises.

#### Public nuisance

2.15 The 2003 Act enables licensing authorities and responsible authorities, through representations, to consider what constitutes public nuisance and what is appropriate to prevent it in terms of conditions attached to specific premises licences and club premises certificates. It is therefore important that in considering the promotion of this licensing objective, licensing authorities and responsible authorities focus on the effect of the licensable activities at the specific premises on persons living and working (including those carrying on business) in the area around the premises which may be disproportionate and unreasonable. The issues will mainly concern noise nuisance, light pollution, noxious smells and litter.

2.16 Public nuisance is given a statutory meaning in many pieces of legislation. It is however not narrowly defined in the 2003 Act and retains its broad common law meaning. It may include in appropriate circumstances the reduction of the living and working amenity and environment of other persons living and working in the area of the licensed premises. Public nuisance may also arise as a result of the adverse effects of artificial light, dust, odour and insects or where its effect is prejudicial to health.

2.18 As with all conditions, those relating to noise nuisance may not be appropriate in certain circumstances where provisions in other legislation adequately protect those living in the area of the premises. But as stated earlier in this Guidance, the approach of licensing authorities and responsible authorities should be one of prevention and when their powers are engaged, licensing authorities should be aware of the fact that other legislation may not adequately cover concerns raised in relevant representations and additional conditions may be appropriate.

## Protection of Children from harm

2.22 The protection of children from harm includes the protection of children from moral, psychological and physical harm. This includes not only protecting children from the harms associated directly to alcohol consumption but also wider harms such as exposure to strong language and sexual expletives (for example, in the context of exposure to certain films or adult entertainment). Licensing authorities must also consider the need to protect children from sexual exploitation when undertaking licensing functions.

2.23 The Government believes that it is completely unacceptable to sell alcohol to children. Conditions relating to the access of children where alcohol is sold and which are appropriate to protect them from harm should be carefully considered.

- A member or members of the current management have been convicted for serving alcohol to minors or with a reputation for allowing underage drinking (other than in the context of the exemption in the 2003 Act relating to 16 and 17 year olds consuming beer, wine and cider when accompanied by an adult during a table meal);

2.26 Licensing authorities and responsible authorities should expect applicants, when preparing an operating schedule or club operating schedule, to set out the steps to be taken to protect children from harm when on the premises.

2.28 Please see also Chapter 10 for details about the Licensing Act 2003 (Mandatory Licensing Conditions) Order 2010.

2.29 Licensing authorities should give considerable weight to representations about child protection matters. In addition to the responsible authority whose functions relate directly to child protection, the Director Public Health may also have access to relevant evidence to inform such representations. These representations may include, amongst other things, the use of health data about the harms that alcohol can cause to underage drinkers. Where a responsible authority, or other person, presents evidence to the licensing authority linking specific premises with harms to children (such as ambulance data or emergency department attendances by persons under 18 year old with alcohol-related illness or injuries) this evidence should be considered, and the licensing authority should also consider what action is appropriate to ensure this licensing objective is effectively enforced. In relation to applications for the grant of a licence in areas where evidence is presented on high levels of alcohol-related harms in persons aged under 18, it is recommended that the licensing authority considers what conditions may be appropriate to ensure that this objective is promoted effectively.

Offences relating to the sale and supply of alcohol to children

2.32 Licensing authorities are expected to maintain close contact with the police, young offenders' teams and trading standards officers (who can carry out test purchases under section 154 of the 2003 Act) about the extent of unlawful sales and consumption of alcohol by minors and to be involved in the development of any strategies to control or prevent these unlawful activities and to pursue prosecutions. Licensing authorities, alongside the police, are prosecuting authorities for the purposes of these offences, except for the offences under section 147A (persistently selling alcohol to children). Where, as a matter of policy, warnings are given to retailers prior to any decision to prosecute in respect of an offence, it is important that each of the enforcement arms should be aware of the warnings each of them has given.

### **The following relevant section of RBWM Licensing Policy (2016 – 2021):-**

#### **9. Promoting the Prevention of Public Nuisance**

Where relevant representations are made, the Licensing Authority will have particular regard to the following issues in relation to the public nuisance objective:

- The disposal of waste, particularly glass
- The use and maintenance of plant, including air extraction and ventilation systems
- Litter in the vicinity of the premises
- Noise from deliveries / collections to and from the premises
- Measures to control behaviour and queues
- Whether door supervisors are able to stay at the entrance to encourage quiet departure
- The provision of Hackney Carriage / Private Hire services at the premises
- Signs on doors and on tables encouraging consideration to the neighbours

### **6. Key Strategies for 2016 – 2021**

#### **6.1 Framework Hours**

The current staggered closing times of licensed premises, that has developed since 2005 in the Royal Borough, has helped to reduce the problems associated with large numbers of people leaving premises at the same time and reduced congestion at taxi ranks and fast food outlets. However, the later opening hours have brought increased levels of crime, disorder and nuisance. Responsible Authorities, local residents and local Councillors have reported many issues, including noise, anti-social behaviour and litter, which are having an adverse impact on their quality of life. In particular, there has been an increase in violent crime in Windsor town centre between the hours of 00:00 and 04:00.

Having considered the evidence of alcohol related crime, disorder and anti-social behaviour, the number of late night premises and, in particular, the social, practical and regulatory impacts on the morning after the night before, the Licensing Authority

has adopted a Framework Hours Policy. This Framework Hours Policy will apply to new and variation applications.

The Framework Hours are: Premises Type:	Commencement Hour for Licensable Activities No earlier than :	Terminal Hour for Licensable Activities No later than:
• Off licence	• 09:00am	• 11:00pm
• Restaurant	• 09:00am	• 01:00am
• Pub/Bars/Night Clubs	• 10:00am	• 02:00am
• Takeaways	• n/a	• 02:00am

Have greater freedom to operate outside framework hours. Such venues are predominantly seated. Examples include:

- Theatres
- Cinemas
- Qualifying Clubs

For the purpose of this policy, premises shall be considered as a restaurant or café if the sale of alcohol is made only to seated customers who are also dining and where this is a condition of the licence, or a condition volunteered in the Operating Schedule for the premises. Where such conditions have not been offered, the premises will be treated as a public house.

Framework Hours are intended to guide applicants on the Licensing Authority's expectations when preparing their Operating Schedule. However, if no relevant representations are received, the application will be granted by the Licensing Authority under delegated powers.

Any conditions setting out hours of premises refers, unless otherwise stated, to the hours during which licensable activities may take place pursuant to the Premises Licence or Club premises Certificate. The Licensing Authority expects the premises to close thirty minutes after the terminal hour for the latest licensable activity.

#### 6.4 Wider Community Interest

The Licensing Authority considers that its licensing functions are exercised in the public interest, furthermore that the licensing authority is under a duty to take any steps with a view to the promotion of the licensing objectives in the interests of the wider community and not just those of the individual licence holder.

The Licensing Authority will have particular regard to those applications in close proximity to residential premises and the likely effect on the promotion of the licensing objectives in such circumstances. Subject to any relevant representations, the Licensing Authority will have particular regard to:

- The nature of the activities
- The character of the surrounding area

## **E) Observations.**

The Sub Committee is obliged to determine this application with a view to promoting the licensing objectives which are:

- The prevention of crime and disorder;
- Public safety;
- The prevention of public nuisance
- The protection of children from harm.

In making its decision, the Committee is also obliged to have regard to national guidance and the Council's own Licensing Policy. Of course, the Committee must have regard to all of the representations made and the evidence it hears.

The Committee must take such of the following steps as it considers appropriate for the promotion of the licensing objectives:

- Grant the application as asked.
- Modify the conditions of the licence, by altering or omitting or adding to them.
- Reject the whole or part of the application.





30/11/11

5868280

**Application for a premises licence to be granted  
under the Licensing Act 2003**

**PLEASE READ THE FOLLOWING INSTRUCTIONS FIRST**

Before completing this form please read the guidance notes at the end of the form. If you are completing this form by hand please write legibly in block capitals. In all cases ensure that your answers are inside the boxes and written in black ink. Use additional sheets if necessary.

You may wish to keep a copy of the completed form for your records.

I/We CHARAL PATEL  
*(Insert name(s) of applicant)*

apply for a premises licence under section 17 of the Licensing Act 2003 for the premises described in Part 1 below (the premises) and I/we are making this application to you as the relevant licensing authority in accordance with section 12 of the Licensing Act 2003

**Part 1 – Premises details**

Postal address of premises or, if none, ordnance survey map reference or description <b>COSTCUTTER 113-117 SPRINGFIELD ROAD</b>			
Post town	WINDSOR	Postcode	SL4 3PZ

Telephone number at premises (if any)	
Non-domestic rateable value of premises	<b>£26250</b>

**Part 2 - Applicant details**

Please state whether you are applying for a premises licence as      Please tick as appropriate

- a) an individual or individuals \*       please complete section (A)
- b) a person other than an individual \*
  - i as a limited company/limited liability partnership       please complete section (B)
  - ii as a partnership (other than limited liability)       please complete section (B)
  - iii as an unincorporated association or       please complete section (B)
  - iv other (for example a statutory corporation)       please complete section (B)
- c) a recognised club       please complete section (B)
- d) a charity       please complete section (B)

- e) the proprietor of an educational establishment  please complete section (B)
- f) a health service body  please complete section (B)
- g) a person who is registered under Part 2 of the Care Standards Act 2000 (c14) in respect of an independent hospital in Wales  please complete section (B)
- ga) a person who is registered under Chapter 2 of Part 1 of the Health and Social Care Act 2008 (within the meaning of that Part) in an independent hospital in England  please complete section (B)
- h) the chief officer of police of a police force in England and Wales  please complete section (B)

\* If you are applying as a person described in (a) or (b) please confirm (by ticking yes to one box below):

- I am carrying on or proposing to carry on a business which involves the use of the premises for licensable activities; or
- I am making the application pursuant to a statutory function or
- a function discharged by virtue of Her Majesty's prerogative

**(A) INDIVIDUAL APPLICANTS (fill in as applicable)**

Mr <input type="checkbox"/>		Mrs <input checked="" type="checkbox"/>		Miss <input type="checkbox"/>		Ms <input type="checkbox"/>		Other Title (for example, Rev)			
Surname <b>PATEL</b>					First names <b>CHARUL</b>						
Date of birth <b>6/10/76</b>				I am 18 years old or				<input checked="" type="checkbox"/> Please tick yes			
Nationality <b>BRITISH</b>											
Current residential address if different from premises address				4 MARBECK CLOSE							
Post town		<b>WINDSOR</b>				Postcode		<b>SL4 5RB</b>			
Daytime contact telephone number											
E-mail address (optional)											

**SECOND INDIVIDUAL APPLICANT (if applicable)**

Mr <input type="checkbox"/>		Mrs <input type="checkbox"/>		Miss <input type="checkbox"/>		Ms <input type="checkbox"/>		Other Title (for example, Rev)		
-----------------------------	--	------------------------------	--	-------------------------------	--	-----------------------------	--	--------------------------------	--	--

When do you want the premises licence to start?

DD	MM	YYYY
0	1	12 2 0 18

If you wish the licence to be valid only for a limited period, when do you want it to end?

DD	MM	YYYY

Please give a general description of the premises (please read guidance note 1)

The premises will be a convenience store. The application is off sales only. Fresh food and all other types of goods will be sold including toiletries, household, frozen food, newspapers etc.

If 5,000 or more people are expected to attend the premises at any one time, please state the number expected to attend.

What licensable activities do you intend to carry on from the premises?

(please see sections 1 and 14 and Schedules 1 and 2 to the Licensing Act 2003)

Provision of regulated entertainment (please read guidance note 2)

Please tick all that apply

- a) plays (if ticking yes, fill in box A)
- b) films (if ticking yes, fill in box B)
- c) indoor sporting events (if ticking yes, fill in box C)
- d) boxing or wrestling entertainment (if ticking yes, fill in box D)
- e) live music (if ticking yes, fill in box E)
- f) recorded music (if ticking yes, fill in box F)
- g) performances of dance (if ticking yes, fill in box G)
- h) anything of a similar description to that falling within (e), (f) or (g) (if ticking yes, fill in box H)

<b>Surname</b>		<b>First names</b>	
<b>Date of birth over</b>		I am 18 years old or	<input type="checkbox"/> Please tick yes
<b>Nationality</b>			
Current residential address if different from premises address			
Post town		Postcode	
<b>Daytime contact telephone number</b>			
<b>E-mail address (optional)</b>			

**(B) OTHER APPLICANTS**

Please provide name and registered address of applicant in full. Where appropriate please give any registered number. In the case of a partnership or other joint venture (other than a body corporate), please give the name and address of each party concerned.

Name
Address
Registered number (where applicable)
Description of applicant (for example, partnership, company, unincorporated association etc.)
Telephone number (if any)
E-mail address (optional)

**Part 3 Operating Schedule**

**Provision of late night refreshment** (if ticking yes, fill in box I)

**Supply of alcohol** (if ticking yes, fill in box J)

**In all cases complete boxes K, L and M**

**A**

<b>Plays</b> Standard days and timings (please read guidance note 7)			<b>Will the performance of a play take place indoors or outdoors or both – please tick</b> (please read guidance note 3)	Indoors	<input type="checkbox"/>
				Outdoors	<input type="checkbox"/>
Day	Start	Finish		Both	<input type="checkbox"/>
Mon			<b>Please give further details here</b> (please read guidance note 4)		
Tue					
Wed			<b>State any seasonal variations for performing plays</b> (please read guidance note 5)		
Thur					
Fri			<b>On standard timings. Where you intend to use the premises for the performance of plays at different times to those listed in the column on the left, please list</b> (please read guidance note 6)		
Sat					
Sun					

**B**

<b>Films</b> Standard days and timings (please read guidance note 7)			<b>Will the exhibition of films take place indoors or outdoors or both – please tick</b> (please read guidance note 3)	Indoors <input type="checkbox"/>	
				Outdoors <input type="checkbox"/>	
				Both <input type="checkbox"/>	
<b>Day</b>	<b>Start</b>	<b>Finish</b>	<b>Please give further details here</b> (please read guidance note 4)		
Mon					
Tue					
Wed			<b>State any seasonal variations for the exhibition of films</b> (please read guidance note 5)		
Thur					
Fri					
Sat			<b>Non standard timings. Where you intend to use the premises for the exhibition of films at different times to those listed in the column on the left, please list</b> (please read guidance note 6)		
Sun					

C

Indoor sporting events Standard days and timings (please read guidance note 7)			Please give further details (please read guidance note 4)
Day	Start	Finish	
Mon			State any seasonal variations for indoor sporting events (please read guidance note 5)
Tue			
Wed			Non standard timings. Where you intend to use the premises for indoor sporting events at different times to those listed in the column on the left, please list (please read guidance note 6)
Thur			
Fri			
Sat			
Sun			



**D**

<b>Boxing or wrestling entertainments</b> Standard days and timings (please read guidance note 7)			<b>Will the boxing or wrestling entertainment take place indoors or outdoors or both – please tick</b> (please read guidance note 3)		Indoors <input type="checkbox"/>
					Outdoors <input type="checkbox"/>
Day	Start	Finish	Both <input type="checkbox"/>		
Mon			<b>Please give further details here</b> (please read guidance note 4)		
Tue					
Wed			<b>State any seasonal variations for boxing or wrestling entertainment</b> (please read guidance note 5)		
Thur					
Fri			<b>on standard timings. Where you intend to use the premises for boxing or wrestling entertainment at different times to those listed in the column on the left, please list</b> (please read guidance note 6)		
Sat					
Sun					

**E**

<b>Live music</b> Standard days and timings (please read guidance note 7)			<b>Will the performance of live music take place indoors or outdoors or both – please tick</b> (please read guidance note 3)	
			Indoors	<input type="checkbox"/>
			Outdoors	<input type="checkbox"/>
			Both	<input type="checkbox"/>
<b>Day</b>	<b>Start</b>	<b>Finish</b>	<b>Please give further details here</b> (please read guidance note 4)	
Mon				
Tue				
Wed			<b>State any seasonal variations for the performance of live music</b> (please read guidance note 5)	
Thur				
Fri				
Sat			<b>On standard timings. Where you intend to use the premises for the performance of live music at different times to those listed in the column on the left, please list</b> (please read guidance note 6)	
Sun				

**F**

<b>Recorded music</b> Standard days and timings (please read guidance note 7)			<b>Will the playing of recorded music take place indoors or outdoors or both – please tick</b> (please read guidance note 3)		Indoors <input type="checkbox"/>
					Outdoors <input type="checkbox"/>
					Both <input type="checkbox"/>
Day	Start	Finish	<b>Please give further details here</b> (please read guidance note 4)		
Mon					
Tue					
Wed			<b>State any seasonal variations for the playing of recorded music</b> (please read guidance note 5)		
Thur					
Fri					
Sat			<b>Non standard timings. Where you intend to use the premises for the playing of recorded music at different times to those listed in the column on the left, please list</b> (please read guidance note 6)		
Sun					

**G**

Performances of dance Standard days and timings (please read guidance note 7)			<u>Will the performance of dance take place indoors or outdoors or both – please tick</u> (please read guidance note 3)	
Day	Start	Finish	Indoors	<input type="checkbox"/>
Mon			Outdoors	<input type="checkbox"/>
Tue			Both	<input type="checkbox"/>
Wed			<u>Please give further details here</u> (please read guidance note 4)	
Thur			<u>State any seasonal variations for the performance of dance</u> (please read guidance note 5)	
Fri			<u>When standard timings. Where you intend to use the premises for the performance of dance at different times to those listed in the column on the left, please list</u> (please read guidance note 6)	
Sat				
Sun				

**H**

<p><b>Anything of a similar description to that falling within (e), (f) or (g)</b> Standard days and timings (please read guidance note 7)</p>			<p>Please give a description of the type of entertainment you will be providing</p>		
Day	Start	Finish	<p><b>Will this entertainment take place indoors or outdoors or both – please tick</b> (please read guidance note 3)</p>	Indoors	<input type="checkbox"/>
Mon				Outdoors	<input type="checkbox"/>
				Both	<input type="checkbox"/>
Tue			<p><b>Please give further details here</b> (please read guidance note 4)</p>		
Wed					
Thur			<p><b>State any seasonal variations for entertainment of a similar description to that falling within (e), (f) or (g)</b> (please read guidance note 5)</p>		
Fri					
Sat			<p><b>Non standard timings. Where you intend to use the premises for the entertainment of a similar description to that falling within (e), (f) or (g) at different times to those listed in the column on the left, please list</b> (please read guidance note 6)</p>		
Sun					

**I**

<b>Late night refreshment</b> Standard days and timings (please read guidance note 7)			<b>Will the provision of late night refreshment take place indoors or outdoors or both – please tick (please read guidance note 3)</b>			
			Indoors	<input type="checkbox"/>		
			Outdoors	<input type="checkbox"/>		
			Both	<input type="checkbox"/>		
<b>Day</b>	<b>Start</b>	<b>Finish</b>	<b>Please give further details here (please read guidance note 4)</b>			
Mon						
Tue						
Wed					<b>State any seasonal variations for the provision of late night refreshment (please read guidance note 5)</b>	
Thur						
Fri					<b>on standard timings. Where you intend to use the premises for the provision of late night refreshment at different times, to those listed in the column on the left, please list (please read guidance note 6)</b>	
Sat						
Sun						

**J**

<b>Supply of alcohol</b> Standard days and timings (please read guidance note 7)			<b>Will the supply of alcohol be for consumption – please tick</b> (please read guidance note 8)	On the premises	<input type="checkbox"/>
				Off the premises	<input checked="" type="checkbox"/>
				Both	<input type="checkbox"/>
Day	Start	Finish	<b>State any seasonal variations for the supply of alcohol</b> (please read guidance note 5)		
Mon	0600	2300			
Tue	0600	2300			
Wed	0600	2300			
Thur	0600	2300			
Fri	0600	2300			
Sat	0600	2300			
Sun	0600	2300			
			<b>Non standard timings. Where you intend to use the premises for the supply of alcohol at different times to those listed in the column on the left, please list</b> (please read guidance note 6)		

**State the name and details of the individual whom you wish to specify on the licence as designated premises supervisor (Please see declaration about the entitlement to work in the checklist at the end of the form):**

Name CHARUL PATEL	
Date of birth 6/10/76	
Address 4 MARBECK CLOSE WINDSOR	
Postcode	SL4 5RB
Personal licence number (if known) 09/00621/LIPERS	
Issuing licensing authority (if known) CROYDON COUNCIL	

K

**Please highlight any adult entertainment or services, activities, other entertainment or matters ancillary to the use of the premises that may give rise to concern in respect of children (please read guidance note 9).**

None

L

<b>Hours premises are open to the public</b> Standard days and timings (please read guidance note 7)			<b>State any seasonal variations</b> (please read guidance note 5)
Day	Start	Finish	
Mon	0600	2300	<p><b><u>Non standard timings. Where you intend the premises to be open to the public at different times from those listed in the column on the left, please list</u></b> (please read guidance note 6)</p>
Tue	0600	2300	
Wed	0600	2300	
Thur	0600	2300	
Fri	0600	2300	
Sat	0600	2300	
Sun	0600	2300	



**M** Describe the steps you intend to take to promote the four licensing objectives:

**a) General – all four licensing objectives (b, c, d and e) (please read guidance note 10)**

Staff will be trained before making sales of alcohol in their responsibilities under the Licensing Act 2003. Training will be documented & made available to the Police & authorised officers of the council upon reasonable request.

**b) The prevention of crime and disorder**

A CCTV system will be in operation at the premises and recorded images shall be retained for a period of 30 days. CCTV images will be provided to the police and other responsible authorities as soon as practicable and in any case within 48 hours of a request for such images, subject of the provisions of the DPA.

A register of refusals of alcohol will be maintained at the premises. The register shall be examined on a regular basis by the duty manager/ DPS and the date and time of each examination will be endorsed in the register. The register will be made available for inspection by the Police and other authorised officers of the council upon reasonable request.

**c) Public safety**

An incident register will be maintained at the premises and made available to the authorities on request.

**d) The prevention of public nuisance**

A notice will be on display asking that the customers leave the area quietly and respect the local residents.

All staff at the store will be trained in how to manage any person who they suspect may create a public nuisance in the area of the store. Such people will be asked to leave the area quietly (if safe to do so) an entry will be made in the incident register.

**e) The protection of children from harm**

The premises will adopt a 'Challenge 25' policy. This means that if a customer purchasing alcohol appears to be under the age of 25 they will be asked for proof of their age, to prove that they are 18 years or older.

Posters will be on display advising customers of the 'Challenge 25' policy.

The only forms of identification that will be accepted at the premises are a passport, UK photo-card driving licences, & cards bearing the 'PASS' hologram.

**Checklist:**

**Please tick to indicate agreement**

- I have made or enclosed payment of the fee.
- I have enclosed the plan of the premises.
- I have sent copies of this application and the plan to responsible authorities and others where applicable.
- I have enclosed the consent form completed by the individual I wish to be designated premises supervisor, if applicable.
- I understand that I must now advertise my application.
- I understand that if I do not comply with the above requirements my application will be rejected.
- [Applicable to all individual applicants, including those in a partnership which is not a limited liability partnership, but not companies or limited liability partnerships] I have included documents demonstrating my entitlement to work in the United Kingdom (please read note 15).

**IT IS AN OFFENCE, UNDER SECTION 158 OF THE LICENSING ACT 2003, TO MAKE A FALSE STATEMENT IN OR IN CONNECTION WITH THIS APPLICATION. THOSE WHO MAKE A FALSE STATEMENT MAY BE LIABLE ON SUMMARY CONVICTION TO A FINE OF ANY AMOUNT.**

**IT IS AN OFFENCE UNDER SECTION 24B OF THE IMMIGRATION ACT 1971 FOR A PERSON TO WORK WHEN THEY KNOW, OR HAVE REASONABLE CAUSE TO BELIEVE, THAT THEY ARE DISQUALIFIED FROM DOING SO BY REASON OF THEIR IMMIGRATION STATUS. THOSE WHO EMPLOY AN ADULT WITHOUT LEAVE OR WHO IS SUBJECT TO CONDITIONS AS TO EMPLOYMENT WILL BE LIABLE TO A CIVIL PENALTY UNDER SECTION 15 OF THE IMMIGRATION, ASYLUM AND NATIONALITY ACT 2006 AND PURSUANT TO SECTION 21 OF THE SAME ACT, WILL BE COMMITTING AN OFFENCE WHERE THEY DO SO IN THE KNOWLEDGE, OR WITH REASONABLE CAUSE TO BELIEVE, THAT THE EMPLOYEE IS DISQUALIFIED.**

**Part 4 – Signatures** (please read guidance note 11)

**Signature of applicant or applicant's solicitor or other duly authorised agent** (see guidance note 12). **If signing on behalf of the applicant, please state in what capacity.**

<b>Declaration</b>	<ul style="list-style-type: none"> <li>• [Applicable to individual applicants only, including those in a partnership which is not a limited liability partnership] I understand I am not entitled to be issued with a licence if I do not have the entitlement to live and work in the UK (or if I am subject to a condition preventing me from doing work relating to the carrying on of a licensable activity) and that my licence will become invalid if I cease to be entitled to live and work in the UK (please read guidance note 15).</li> <li>• The DPS named in this application form is entitled to work in the UK (and is not subject to conditions preventing him or her from doing work relating to a licensable activity) and I have seen a copy of his or her proof of entitlement to work, if appropriate (please see note 15)</li> </ul>
Signature	 PAUL SHERRATT
Date	2/11/18
Capacity	Authorised agent

**For joint applications, signature of 2<sup>nd</sup> applicant or 2<sup>nd</sup> applicant's solicitor or other authorised agent** (please read guidance note 13). **If signing on behalf of the applicant, please state in what capacity.**

Signature	
Date	
Capacity	

Contact name (where not previously given) and postal address for correspondence associated with this application (please read guidance note 14)			
Licensing Matters Ltd 54 Fairfield Drive			
Post town	<b>Clitheroe</b>	Postcode	<b>BB7 2PE</b>
Telephone number (if any)	01282 500322		
If you would prefer us to correspond with you by e-mail, your e-mail address (optional) paul@licensingmatters.net			



**Consent of individual to being specified as premises supervisor**

I CHARUL PATEL

of 4 MARBECK CLOSE  
WINDSOR  
SL4 5RB

Date of birth: 06/10/76

Place of birth: INDIA (GUJARAT)

Nationality: BRITISH

hereby confirm that I give my consent to be specified as the designated premises supervisor in relation to the application for

**PREMISES LICENCE GRANT**

by

CHARUL PATEL

relating to a premises licence TBA

for

COSTCUTTER  
113-117 SPRINGFIELD ROAD  
WINDSOR  
SL4 3PZ

and any premises licence to be granted or varied in respect of this application made by

CHARUL PATEL

[name of applicant]

concerning the supply of alcohol at

COSTCUTTER  
113-117 SPRINGFIELD ROAD  
WINDSOR  
SL4 3PZ

I also confirm that I am entitled to work in the United Kingdom and am applying for, intend to apply for or currently hold a personal licence, details of which I set out below.

Personal licence number

09100621/LI PERS

Personal licence issuing authority

CROYDON COUNCIL

Signed

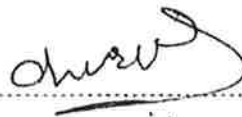

Name (please print)

CHARUL PATEL

Date

23/10/18

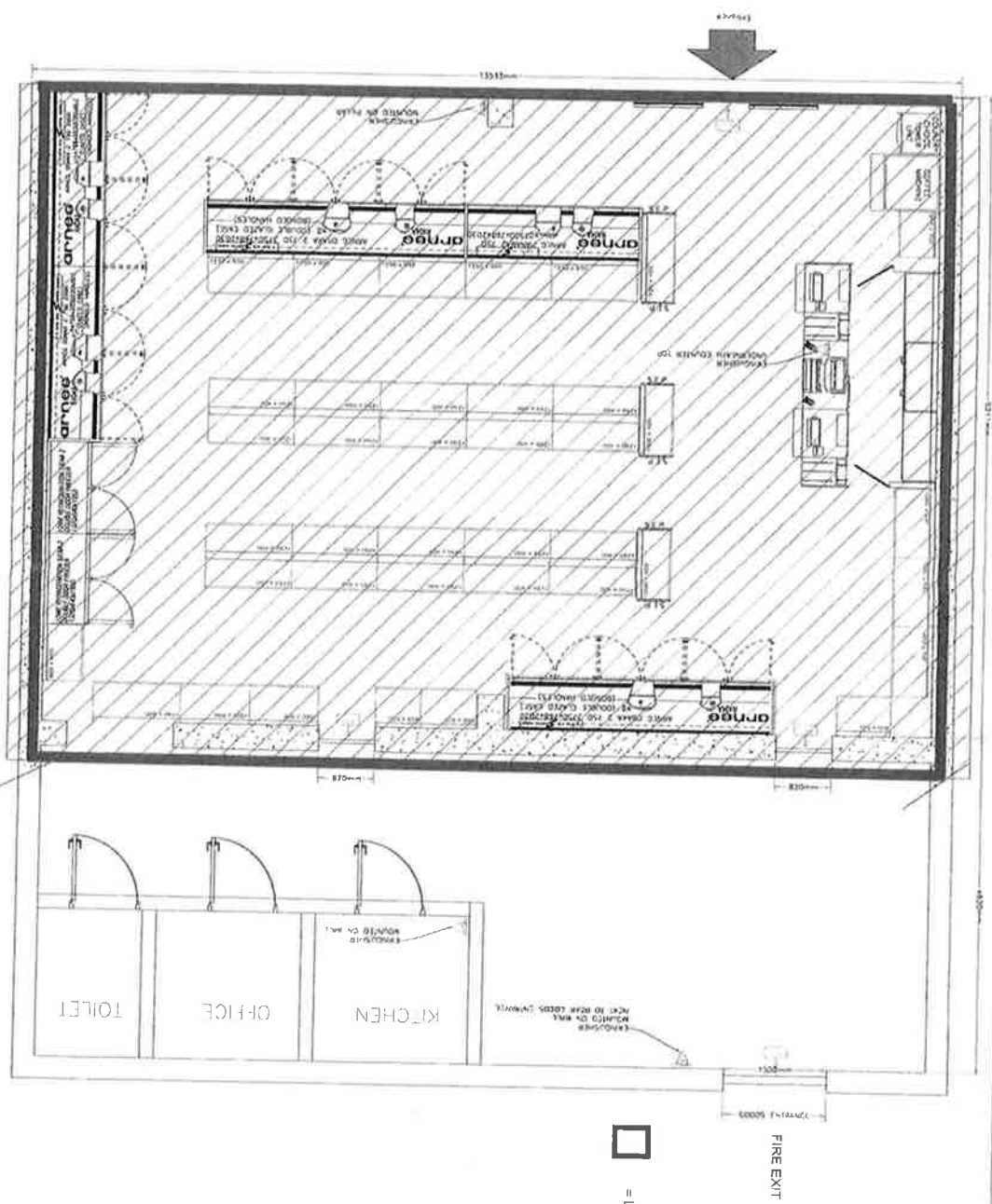

DETAILS  
 SPRINGFIELD ROOM  
 WINDSOR  
 SL 4/90  
 TBC  
 TBC

**Costcutter**  
 Harvest Mills, Common Road,  
 Dunnington, York, YO19 5RY  
 Telephone: 01904 488663 Fax  
 01904 489828

**DISCLAIMER NOTICE**  
 THIS DRAWING IS THE PROPERTY OF COSTCUTTER  
 SUPERMARKETS LTD AND MUST NOT BE COPIED OR  
 REPRODUCED WITHOUT THE EXPRESS  
 WRITTEN PERMISSION OF COSTCUTTER LTD.  
 ANY THIRD PARTY WHOSE NAME IS MENTIONED TO  
 BE CONSULTED IN CONNECTION WITH THIS DRAWING  
 ARE NOT TO BE HELD RESPONSIBLE FOR ANY  
 ERRORS OR OMISSIONS WHICH MAY OCCUR  
 IN CONNECTION WITH THIS DRAWING. ALL DIMENSIONS  
 ARE TO UNLESS OTHERWISE STATED TO  
 BE VERIFIED PRIOR TO WORK COMMENCEMENT.



DRAWING NUMBER  
 OFF LICENCE REQUEST PLAN

REVISION  
 OFF LICENCE REQUEST PLAN

DRAWN BY  
 M. BAKER  
 COSTCUTTER  
 STORE DEVELOPMENT  
 MANAGER

DATE  
 21/10/98

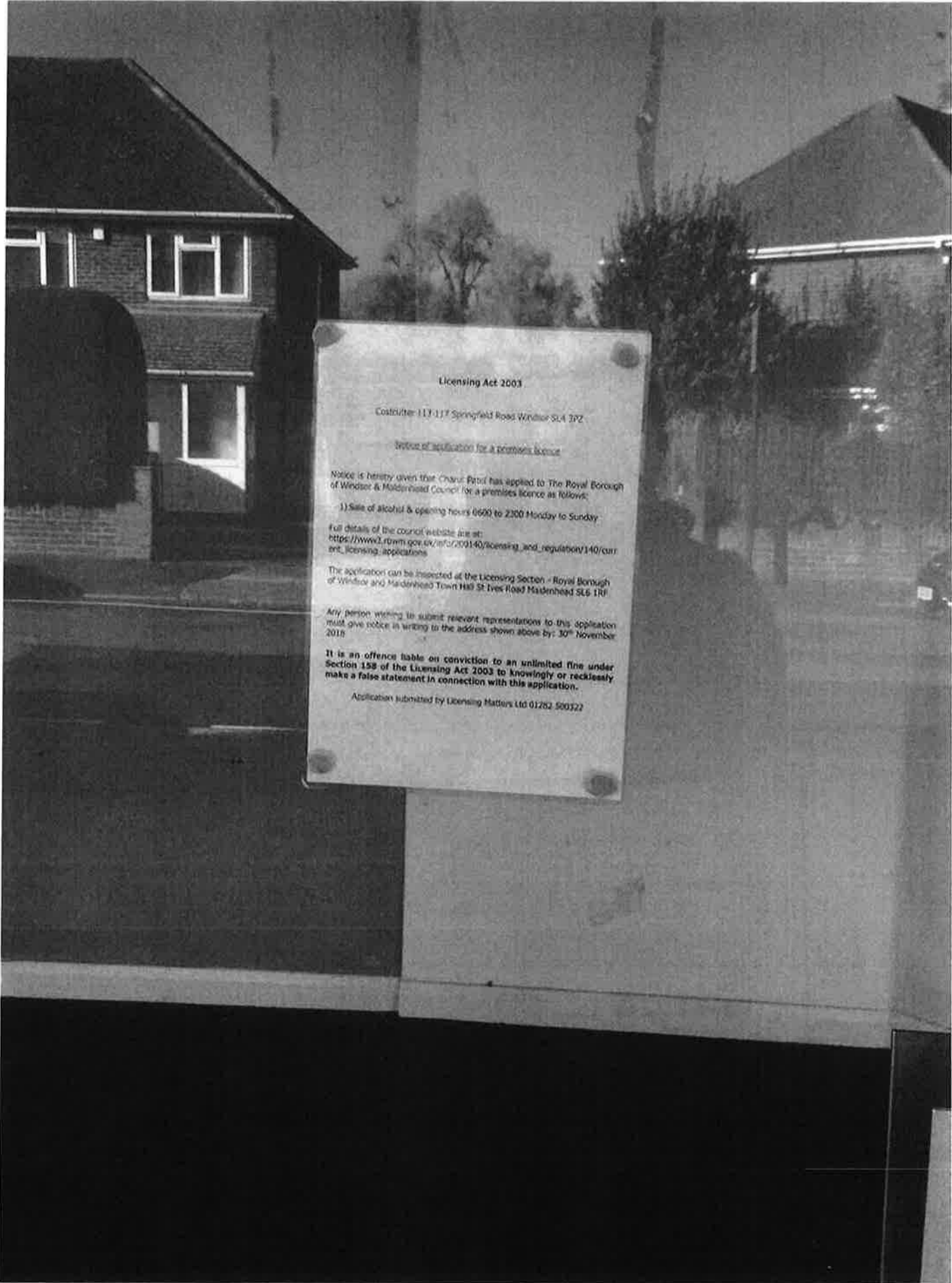

**Licensing Act 2003**

Coastlute 117-117 Springfield Road Windsor SL4 3PZ

*Notice of application for a premises licence*

Notice is hereby given that Charut-Patrol has applied to The Royal Borough of Windsor & Maidenhead Council for a premises licence as follows:

- 1) Sale of alcohol & opening hours 0600 to 2300 Monday to Sunday

Full details of the council website are at:  
[https://www2.rbm.gov.uk/inf/2/209140/licensing\\_and\\_regulation/140/current\\_licensing\\_applications](https://www2.rbm.gov.uk/inf/2/209140/licensing_and_regulation/140/current_licensing_applications)

The application can be inspected at the Licensing Section - Royal Borough of Windsor and Maidenhead Town H00 St Ives Road Maidenhead SL6 1RF

Any person wishing to submit relevant representations to this application must give notice in writing to the address shown above by: 30<sup>th</sup> November 2018

**It is an offence liable on conviction to an unlimited fine under Section 158 of the Licensing Act 2003 to knowingly or recklessly make a false statement in connection with this application.**

Application submitted by Licensing Matters Ltd 01292 500322



Public notices / News

01753 825111

Follow us on Instagram: windsorsloughexpress



Flowers left at the scene

Family's tribute to cyclist killed in collision

SLOUGH: Tributes have been paid to a 'hardworking, loyal and devoted' family man who died in a road traffic collision in Buckingham Avenue on Friday, November 9. The incident occurred at the junction with Dover Road at 6.30am and involved a white and red curtain-sided HGV and a bicycle. The cyclist, Edward McGovern, 64, from Slough, was pronounced dead at the scene. In a statement released by Thames Valley Police, his family said: "Eddie was a hardworking loyal man who was devoted to his family. "He would do anything for anyone, and will be greatly missed." Investigating officer PC Naomi James, of the Serious Collision Investigation Unit, said: "I am appealing to anyone with information or anyone who saw the collision itself, or saw either vehicle before the collision." Contact police by visiting www.thamesvalley.police.uk/ta/tell-us-about/cor/tell-us-about-existing-case/report/ or by calling 101, quoting reference number 43180342655 to share information.

SOULHURSTS DISTRICT COUNCIL Town and Country Planning Act 1990 (Planning (Listed Buildings and Conservation Areas) Regulations 1999) Notice is hereby given that the following Applications have been submitted to the Council for planning permission in accordance with the provisions of the Act. The relevant addresses are listed below. If you wish to object to the proposed development, you should submit your objections to the Council in writing to the Planning Officer, 111 High Street, Slough, Berkshire SL1 1JL, by 10.00am on 27th November 2018. The Council will consider all objections received by this date. If you have any queries, please contact the Planning Officer on 01753 825111.

Sections 1, 32, 35, 46 and 53 of the Road Traffic Regulation Act 1984 and regulation 7 of the Local Authorities Traffic Orders (Procedure) (England and Wales) Regulations 1996 as amended. THE BOROUGH OF SLOUGH WAITING RESTRICTIONS AND PARKING PLACES (CONSOLIDATION) ORDER 2017 (AMENDMENT NO. 1D) ORDER 2018 (Order 42 of 2018)

SLOUGH BOROUGH COUNCIL Section 14(1) of the Road Traffic Regulation Act 1984 (RTRA 1984) and regulation 3 of the Road Traffic (Temporary Restrictions) Procedure Regulations 1992 Slough Borough Council (Bestobell Road) Order 2018 (Order 41 of 2018) ('Order') 1. SLOUGH BOROUGH COUNCIL (Council) gives notice that it has made an Order under section 14(1) of the RTRA 1984 over an area of the highway being Bestobell Road. 2. The Order is needed: because works are or are proposed to be carried out on or near the road; and because of the likelihood of danger to the public, or of serious damage to the road (not attributable to works on or near the road). 3. The Order shall come into operation at 00:01 hours on Thursday 29th November 2018 for a period of 18 months, or until the works have been completed, although the works are anticipated to be complete by 23:59 hours on Saturday 1st December 2018. The duration of the Order can be extended with the approval of the Secretary of State for Transport. 4. While the Order is in operation it will prohibit all classes of vehicles from using Bestobell Road, Slough. 5. An alternative highway will be available for use while the Order is in force and local diversions will be clearly signed at the location. 6. A copy of the draft Order may be inspected free of charge at the locations listed below between normal working hours (excluding bank holidays and public holidays). 1. St Martins Place, 51 Bath Road, Slough, Berkshire, SL1 3UF; and 2. My Council, Landmark Place, High Street, Slough, SL1 1JL; 7. If you have any queries regarding the proposed work or alternative route please contact: Head of Highways/Traffic, Slough Borough Council, St Martins Place, 51 Bath Road, Slough, Berkshire SL1 3UF Dated: Friday 23rd November 2018

1. SLOUGH BOROUGH COUNCIL gives notice that it proposes to make the Proposed Order under sections 1, 32, 35, 46 and 53 of the Road Traffic Regulation Act 1984 and any other enabling powers. 2. The effect of the Proposed Order is to make the following changes to Elmhurst Road, Slough: (a) to designate the whole of Elmhurst Road as a resident parking zone, except for any parts to which a waiting restriction or disabled persons' parking bay applies (b) to designate the following properties as eligible for resident permits at a current annual cost of £25 for first permits and £50 for second permits:- (i) all residential properties on Elmhurst Road from numbers 2a - 48 (evens); and 1a - 47 (odds) (c) to reduce the existing "No loading and unloading at any time" restrictions at the entry to both sides of Elmhurst road to 12 metres. (d) to introduce "No waiting at any time" restrictions which will act as passing places at the following locations:- (i) the entire length of the turning head (ii) in front of properties 1a and 1 Elmhurst Road (iii) in front of properties 33 and 35 Elmhurst Road 3. Access to properties adjoining Elmhurst Road and the use of the existing disabled persons' parking spaces will not be affected by the Proposed Order. 4. A copy of the Proposed Order, a plan showing the parts of the highway affected and a statement of the traffic authority's reasons for making the Proposed Order may be inspected free of charge at the locations listed below during normal working hours (excluding bank holidays and public holidays). • St Martins Place, 51 Bath Road, Slough, Berkshire, SL1 3UF; • My Council, Landmark Place, High Street, Slough, SL1 1JL; and • Library @ The Curve, William Street, Slough SL1 1XY 5. Anyone wishing to object to the Proposed Order may do so by writing to the address below. The objection must be made in writing, stating the grounds on which it is made, and must be sent so as to arrive no later than three weeks from the date of this Notice. Service Lead - Planning & Transport, Slough Borough Council, St Martins Place, 51 Bath Road, Slough, SL1 3UF 23rd November 2018

SLOUGH BOROUGH COUNCIL Town & Country Planning Act 1990 (as amended) The council has received the following planning applications: Reference Number: P/08249/003 Location: 2, Clifton Road, Slough, SL1 1SP Proposal: Conversion of 3 bedroom dwellinghouse into 2 x 3-bedroom dwellinghouses with single storey rear extension, first floor rear extension & rear dormers to facilitate loft conversion. Reason for notice: Development within Conservation Area Reference Number: P/02933/069 Location: Iron Mountain, 724-729, Dundee Road, Slough, SL1 4JU Proposal: Construction of new external plant areas to serve new data centre hall. Reason for notice: Major Application Reference Number: P/02933/010 Location: Iron Mountain, 724-729, Dundee Road, Slough, SL1 4JU Proposal: Re-clad the front of the building and re-align perimeter fence. Demolish existing sprinkler tank and create a new two storey office extension, on the western side of the building. Reason for notice: Major Application

If you wish to comment on an application, you should do so within 21 days of the date of this notice to planning@slough.gov.uk or the postal address below. Applications can be viewed at www.sbcplanning.co.uk or during office hours at the Planning Department, St Martins Place, 51 Bath Road, Slough, SL1 3UF. Date: 23/11/2018

GOODS VEHICLE OPERATOR'S LICENCE JRS Hauage Ltd, of 56 Charter Crockett, Hounslow TW4 6AY is applying for a licence to use Aggregate Industries, Colnbrook Depot, Colnbrook Bypass, Colnbrook, Slough, Berkshire SL3 0EB as an operating centre for 1 goods vehicles and 0 trailers. Owners or occupiers of land (including buildings) near the operating centre(s) who believe that their use or enjoyment of that land would be affected, should make written representations to the Traffic Commissioner at Hillcrest House 386 Harehills Lane Leam LS9 9NF, stating their reasons, within 21 days of this notice. Representors must at the same time send a copy of their representations to the applicant at the address given at the top of this notice. A Guide to Making Representations is available from the Traffic Commissioner's office.

NOTICE OF APPLICATION TO VARY A PREMISES LICENCE UNDER SECTION 34 OF THE LICENSING ACT 2003 Applicant: A to Z Fresh Ltd Premises: 279 High Street, Slough, SL1 1BN The proposed variation is to permit Late night Refreshment till 2:00 AM Full details of which can be inspected on the application. The licensing register can be inspected at the address noted below during normal business hours. Any representations by an interested party or responsible authority regarding this application can be made to: Slough Borough Council Licensing Team, My Council Landmark Place, High Street, Slough, SL1 1JL Any representations must be made in writing by 11th Dec 2018 clearly stating the grounds upon which the representation is made relevant to the Licensing Act

THE ROYAL BOROUGH OF WINDSOR & MAIDENHEAD (B470 HIGH STREET (PART), DATCHET) (TEMPORARY CLOSURE) ORDER 2018 The Royal Borough of Windsor & Maidenhead has made an Order, the effect of which will be to: Prohibit any vehicle or pedestrian from proceeding along that part of the B470 High Street, Datchet between its junctions with Manor House Lane and The Avenue The alternative route for vehicles and pedestrians affected by the Order will be via the B376 The 'Sieve', Queens Road and the B470 Windsor Road The purpose of the Order is to facilitate works to be executed in and adjacent to the road by Network Rail at the High Street Level Crossing, and as a result, there is the likelihood of danger to the public The Order will come into operation at 23:30 hours on Monday 26 November 2018, and it is anticipated that works will be completed by 05:30 hours on Tuesday 27 November 2018. This Order may be cited as Royal Borough of Windsor & Maidenhead (B470 High Street (part), Datchet) (Temporary Closure) Order 2018 which shall continue in force for a period of eighteen months at such other periods as may be agreed, to allow for further necessary level crossing maintenance at such times when signs as prescribed by the Traffic Sign Regulations and General Directions 2016 are in place to indicate the said restrictions. If you have any query regarding this proposed Order, please contact Ms. Georgia Jackson of Centurion Traffic on behalf of Network Rail. Her telephone number is 01132 775360 Date: 23 November 2018 Ben Smith, RBWM Traffic Manager, Town Hall, Maidenhead SL6 1RF

ANTONIO HUGHES LATE OF BERKSHIRE, DIED THERE ON 21 FEBRUARY 2012 The kin of the above named are requested to apply to BVD, PO Box 2118, Croydon CR9 3QU DX: 326881 Croydon SL1 at www.gov.uk/bereavement, failing which the Treasury Solicitor may take steps to administer the estate.

THE ROYAL BOROUGH OF WINDSOR & MAIDENHEAD GAMBLING ACT 2005 REVIEW OF GAMBLING STATEMENT OF PRINCIPLES In accordance with section 349 of the Gambling Act 2005 The Royal Borough of Windsor & Maidenhead has to review our Gambling Statement of Principles every three years. Our draft statement was published on 14 November 2018 and you can view our document on our website www.rbwm.gov.uk or printed copies are available in the Town Hall and Maidenhead, Windsor and Ascot libraries. We welcome this opportunity to receive your views on this draft statement. All comments will be considered and used to help shape the final statement, which will be considered at the Licensing Panel meeting on 8 January 2019. The Statement of Principles will come into effect on 31 January 2019. Should you have any comments about this draft statement, please send them via email or letter by 11 December 2018 to the following address: Licensing team, Town Hall, St Ives Road, Maidenhead SL6 1RF Email: licensing@rbwm.gov.uk David Scott, Head of Communities, Enforcement and Partnerships

ANTONIO HUGHES LATE OF BERKSHIRE, DIED THERE ON 21 FEBRUARY 2012 The kin of the above named are requested to apply to BVD, PO Box 2118, Croydon CR9 3QU DX: 326881 Croydon SL1 at www.gov.uk/bereavement, failing which the Treasury Solicitor may take steps to administer the estate.

GOVERNMENT LEGAL DEPARTMENT

GOODS VEHICLE OPERATOR'S LICENCE SANDHU ROADLINE LIMITED of 12 Mansel Close, Slough, SL2 5UG is applying for a licence to use Eurostrage, Station Road, Langley, SL3 6FD as an operating centre for 4 goods vehicles and 4 trailers. Owners or occupiers of land (including buildings) near the operating centre(s) who believe that their use or enjoyment of that land would be affected, should make written representations to the Traffic Commissioner at Hillcrest House 386 Harehills Lane Leam LS9 9NF, stating their reasons, within 21 days of this notice. Representors must at the same time send a copy of their representations to the applicant at the address given at the top of this notice. A Guide to Making Representations is available from the Traffic Commissioner's office.

## Katia Russo

---

**From:** Rajinder Mann  
**Sent:** 14 November 2018 16:18  
**To:** Katia Russo; Licensing  
**Subject:** RE: New Premise Licence Application for Costcutter - Windsor

Hello Katia,

Hope you are well,

Re: Costcutter - Windsor

Please find the following conditions that we would like to put forward.

**\* Proxy sales of alcohol will not be permitted - all staff trained to discourage the sale of alcohol to customers on behalf of children.**

**\* Management will ensure ongoing staff training, etc. (All bar staff/staff fully trained and retrained every 6 months which includes to discourage the sale of alcohol to customers on behalf of children).**

**\* A Challenge 25 policy shall be operated at the premises at all times. All staff shall require identification of all customers who appear to be less than 25 years old and wish to purchase alcohol.**

**Acceptable proof of age will be a PASS approved proof of age card, passport, photographic driving licence, or any identification recognised or approved by either the Licensing Authority or Thames Valley Police.**

**No other form of identification shall be accepted unless agreed with the Licensing Authority or Thames Valley Police.**

**\*The Premises Licence Holder shall operate and maintain an up-to-date record of refused sales of alcohol, indicating the date, time, reason for refusal and person refusing. The record shall be reviewed from time to time by the Designated Premises Supervisor or premises licence holder. This information shall be made available upon request to the Licensing Authority, TVP and any other Responsible Authorities.**

**\*Appropriate signage of Challenge 25 policy.**

Kind regards

Mr Rajinder Mann  
Fair Trading Officer  
Trading Standards Service  
Royal Borough of Windsor & Maidenhead  
Tinkers Lane  
Windsor  
Berkshire  
SL4 4LR  
Tel: 01628 683670

Email: [rajinder.mann@rbwm.gov.uk](mailto:rajinder.mann@rbwm.gov.uk)  
GCSx Secure Email: [rajinder.mann@rbwm.gcsx.gov.uk](mailto:rajinder.mann@rbwm.gcsx.gov.uk)

## Katia Russo

---

**From:** paul Sherratt <paul@licensingmatters.net>  
**Sent:** 21 November 2018 11:31  
**To:** Katia Russo  
**Subject:** RE: TS Conditions for Costcutter - Springfield - Windsor

Caution: External email. Think before clicking links or opening attachments.

Hi Katia

I am happy to accept the condition. I was speaking to you as the Licensing Authority as the guidance is clear in that you should not put items on licences that are covered by other legislation or are already law

Kind regards

**Paul Sherratt**



**LICENSING MATTERS**

you serve • we protect

**Office: 01282 500322**

**54 Fairfield Drive Clitheroe BB7 2PE**

The small print

This e mail and any files transmitted with it are confidential and may be protected by legal privilege. If you are not the intended recipient, please notify the sender and delete this e mail from your system. Please do not disclose, copy or use any part of this e mail and / or any attachments. This e mail has been scanned for malicious content but the internet is inherently insecure and Licensing Matters Ltd cannot accept any liability for the integrity of this message or its attachments.

Licensing Matters Ltd is a limited company registered in England and Wales, Registered Number 05822732.  
Registered office: 54 Fairfield Drive Clitheroe BB7 2PE.

**From:** Katia Russo <Katia.Russo@RBWM.gov.uk>  
**Sent:** 21 November 2018 11:29  
**To:** paul Sherratt <paul@licensingmatters.net>  
**Subject:** RE: TS Conditions for Costcutter - Springfield - Windsor

Hi Paul,  
Could you please contact our Trading Standards Officer on 01628 683670

Thank you,

Katia

**From:** paul Sherratt <paul@licensingmatters.net>  
**Sent:** 21 November 2018 10:58

Licensing Section 127 Springfield Road  
To. Royal Borough of Windsor Windsor Berks. SL4 3PZ  
and Maidenhead

Tawn Hall  
St Joes Road  
Maidenhead  
SL6 1RF.

14th Nov. 2018

RECEIVED

15 NOV 2018

LICENSING

Dear Sir

Ref. New Premises Licence

Costcutter 113-117 Springfield Road  
Windsor SL4 3PZ.

My main objection to this application  
is.

- 1 Opening hours 06.00 hrs - 23.00 hrs Mon-~~Fri~~<sup>Sun</sup>
- 2 This will mean more late night traffic
- 3 This area of Springfield Rd, has mostly elderly people, which the off licence will encourage late night noise from cars and young people drinking in the road.
- 4 More daytime traffic near a school and nursery

5 . More rubbish (i.e beer cans + bottles) which elderly residents will be left to pick up

I hope that the off licence will be rejected, and Costcutters food store will have to close at 8PM. not 11-PM

Yours faithfully

J. Manger (Mrs)

RECEIVED  
15 NOV 2018  
LICENSING

126. Springfield Rd  
Windsor S44 3PU

License Section.

Dear Sir

Units at 109 Springfield Rd  
is a general store and an off  
licence open from Ten - 8pm.

There is an application  
in the empty shop next door to open  
another including off licence to close  
at 11pm.

This is really inappropriate  
in a residential area, why have a  
duplicate next to the established  
store and to sell drinks till 11 will  
encourage inappropriate behaviour in  
a built up area. There are other  
such shops within a short distance

RECEIVED

28 NOV 2018

LICENSING

Yours faithfully

B. Birch B.M. BIRCH

122 Springfield Road  
Windsor

SL4 3PU

15-11-18

Re. Postcutter 113-117 Springfield Road

Dear Sir,

I would like to object to this application. My main reasons are:—

1. Opening hours 06:00 hrs to 23:00 hrs Monday to Sunday.
2. Will bring noise to a residential area in the evening.
3. More traffic, day and night.
4. More rubbish left along the road and in gardens.
5. Rowdy behaviour, especially in the evening.
6. We already have a convenience store and do not need another one.

RECEIVED

16 NOV 2018

LICENSING

Yours faithfully

S. G. Jones

24 Cedar Court  
Birchington Road  
Windsor  
Berkshire  
SL4 3QA

07<sup>th</sup> December 2018

To Whom It May Concern:

I am writing to object to the proposed *Costcutter* store at 113-117 Springfield Road, Windsor SL4 3PZ. I do not believe this will bring a positive addition to the locality, and the proposed hours for the sale of alcohol will attract problems in the neighbourhood, and risk safety of the residents.

Springfield Road is the heart of this part of Windsor and we already have a perfectly adequate local shop for all the needs of the locals. Encouraging the very early and very late sale of alcohol may portray the wrong impression of this area. There is a real risk of the area being littered, requiring the council to clean up the area much more often, potential anti-social behaviour and could even have an impact on house prices. Research has shown that these longer licencing hours can create a violence and binge drinking – I do not want this happening on my door step.

I **strongly object** to the *Costcutter* store on Springfield Road.

Yours sincerely,



Alex McNeillie

RECEIVED \_\_\_\_\_  
11 DEC 2018  
LICENSING \_\_\_\_\_



24 Cedar Court  
Birchington Road  
Windsor  
Berkshire  
SL4 3QA

07<sup>th</sup> December 2018

To Whom It May Concern:

I am writing to object to the proposed *Costcutter* store at 113-117 Springfield Road, Windsor SL4 3PZ. I do not believe this will bring a positive addition to the locality, and the proposed hours for the sale of alcohol will attract problems in the neighbourhood, and risk safety of the residents.

Springfield Road is the heart of this part of Windsor and we already have a perfectly adequate local shop for all the needs of the locals. Encouraging the very early and very late sale of alcohol may portray the wrong impression of this area. There is a real risk of the area being littered, requiring the council to clean up the area much more often, potential anti-social behaviour and could even have an impact on house prices. Research has shown that these longer licencing hours can create a violence and binge drinking – I do not want this happening on my door step.

I **strongly object** to the *Costcutter* store on Springfield Road.

Yours sincerely,



Pamela Heggie

RECEIVED  
11 DEC 2018  
LICENSING

**From:** Harbhajan Singh Baidwan [REDACTED]  
**Sent:** 24 November 2018 12:44  
**To:** Licensing <Licensing@RBWM.gov.uk>  
**Subject:** Proposed Off-License and supermarket at 113-117 Springfield Road, Windsor, SL4 3PZ

Licensing Section  
Royal Borough of Windsor and Maidenhead  
Town Hall  
St Ives Road  
Maidenhead, SL6 1RF

Harbhajan Singh Baidwan  
111 Springfield Road  
Windsor, Berkshire  
SL4 3PS

23th November 2018

**Ref: Proposed Off-License and supermarket at 113-117 Springfield Road, Windsor, SL4 3PZ**

Dear Sirs and Madame,

We are writing in connection with the above planning application. We have examined the plans and I know the site well. I wish to object strongly to the proposed Off-Licence and supermarket as this would cause the following issues.

1. **Crime and disorder** - The proposed opening hours of the off-Licence from 6.00 am to 11.00 pm shows Lack of awareness of the local residents and lack of responsibility to the community. With the potential increase in crime with the additional availability of Alcohol until late at night will also cause an interrupted sleep of local residents.
2. **The prevention of public nuisance** – The availability of alcohol to purchase for longer hours would potentially encourage youngsters to hang around on the benches nearby the area until late and misbehave in an anti-social behaviour.
3. **The protection of children from harm** – Increase in traffic due to delivery lorries, parking problems for residents and school would present a danger to the local children attending the local school.
4. **No Requirement** – There is no need for an additional shop with an alcohol Licence on a parade of just three commercial properties. It would rather be far more beneficial to provide the diversity of some other trade that local residents and nearby school can benefit.
5. **Notices for public awareness** – There has been no notice in the local newspapers given by the applicant for public awareness since the application was submitted. The notice of application for a Premises Licence was also deliberately delayed to be displayed approximately two weeks later after the application was submitted

Taking all the above facts into consideration, we strongly object the proposed Off-Licence and supermarket at 113-117 Springfield Road, Windsor, Berkshire SL4 3PZ. If this application is to be decided by councillors, please take this as notice that I would like to speak at the meeting of the committee at which this application is expected to be decided. Please let us know as soon as possible the date of the meeting.

Yours Faithfully,

Mr. Harbhajan Singh Baidwan  
Mrs. Devinder Kaur Baidwan

[REDACTED]  
[REDACTED]

## LICENCE APPLICATION

Premises: Costcutler 113-117 SPRINGFIELD RD SL43 PZ

I wish to make objection to the granting of a licence to sell alcohol on the above premises from 06:00 - 23:00 hrs.

This is a residential area and we certainly do not want disturbance by people buying and drinking alcohol and disposing of the cans and bottles in our gardens.

I fail to understand why the Council has even considered allowing the setting up of a convenience store selling the same products as the one adjoining it and which has given us good service for 50 yrs or more.

IS IT FAIR ?

Mahida Dhanraj  
128 SPRINGFIELD RD  
WINDSOR  
SL 4 3 PU.  
21 Nov. 2018.

Copy to Councillor D. Duck.

RECEIVED  
26 NOV 2018  
LICENSING

Thank you for speaking to me this morning as discussed I have written the objections to the application for Off-Licence for you to forward to Royal Borough Windsor and Maidenhead

licensing council along with other objection letters.

I am writing in connection to the Alcohol licence application no: 200140 for 113-117 Springfield Road, Windsor, SL4 3PZ.

To start with let me provide you a background to us;

1. As I mentioned to you, we have a shop that is next door to the proposed shop that has applied for the Alcohol licence.
2. We have been running this business for 15 years and over that period we built a close relationship with the local residents and have got to know them well and we have seen their young children grow up over the years.
3. We have gone out of our way to prevent crime and disorder and made sure we close the shop early so that neighbours are not disturbed late at night as the business is in residential area.
4. We know the children that come into the shop as we know the parents and make sure, they are not able to obtain alcohol and tobacco and are not loitering with the aim of obtaining the aforesaid.

To summarise the reasons why alcohol licence should not be allowed to the proposed applicant:

1. There is no requirement for another shop with an alcohol licence on a parade of just three commercial properties. It would be far more beneficial to provide diversity of another trade that the local residents and next-door school can benefit from.
2. The hours requested for the alcohol licence (from 6.00 am to 11.00 pm) clearly shows a lack of awareness of the local area and lack of responsibility for the neighbours' welfare.
3. There is school in very close proximity to the shops. It would not provide any benefit (in fact it would be to the detriment of the local area) to have another shop selling alcohol and tobacco and more energy drinks. This is an area where the local residents are concerned and we have worked hard to keep the local youngsters away from.
4. Due to the proposed early and late opening times the youngsters will be able to get late night alcohol and sit on the nearby benches disturbing the neighbours and leading to an increase in anti-social behaviour.
5. The increase in traffic due to delivery lorries will not only cause parking problems but would also present a hazard to local children as well as children from the nearby school.
6. The proposed business is a family run business, with very little staff to take care of residents' welfare.

Having discussed the matter with a number of local residents there is a clear worry about this new business hoping to trade alcohol for the reasons outlined. As a consequence, we strongly object to the granting of any licence.

I would be grateful, if the concerns of our customers and local residents are taken into consideration as regards to the proposed application for the alcohol licence. We believe every effort should be made to stop the granting of the licence and preserve the safety, and peacefulness of the local community.

Thank you

Regards  
Pam Kaur

Annes News  
109 Springfield Road  
Windsor  
SL4 3PZ

**Katia Russo**

---

**From:** Andrew Smith <[REDACTED]>  
**Sent:** 04 December 2018 12:52  
**To:** Licensing  
**Subject:** Application for a Premises Licence at the proposed Costcutter store at 113-117, Springfield Road, Windsor, SL4 3PZ.

Regarding the above captioned application, We notice that the application is for the 'supply of alcohol (OFF premises) from 06.00 to 23.00 Monday to Sunday.

We note that there is no mention of tobacco in this matter. Is tobacco not to be sold?

The purpose of this missive is to lodge our thoughts on this particular application, so as to ensure that the Licensing Team are fully appraised of the circumstances.

As per the Council website, we notice that there is a body called the Windsor & Maidenhead Local Safeguarding Children Board (LSCB). The Council also, apparently, takes into consideration the 'character' of the surrounding area, litter in the vicinity of the premises, and the 'crime/disorder nuisance potential'. Taking all these points, the first thing that springs to mind is the proximity of the premises to the back entrance to the local junior school.

We already have a convenience store in situ, next door to the subject premises at no. 109. They, no doubt, have their own premises certificate enabling the sale of excisable commodities such as alcohol and tobacco. Thus, do we need a second, somewhat larger 'convenience' store in direct competition next door?

Notwithstanding the distinct possibility of a price war between the two establishments, one can foresee a less than amicable relationship between the two!

It should also be noted that No. 109 has been targeted TWICE by burglars, just for the excisable commodities.

The character of the surrounding area is residential, involving both the 'private' and 'social' housing communities. This area has a steady 'traffic' of youngsters, both 'children' and 'young adults' moving through the Springfield Road/York Road area, en route to either the town centre or the 'skate park', just beyond the underpass. The Council will be well aware of the vandal element in our area, given the number of times the underpass wall is repainted!! Drinks, both canned and bottled are purchased locally( whether or not alcoholic) and, once consumed, the can/bottle is tossed into any adjacent front garden, into the road, etc. etc. If it is a glass container, potentially dangerous broken glass is scattered around, all too predictably. Litter is already a growing menace in this locality.

Just have a look regularly, at the cul-de-sac end of York Road! This application by Costcutter (through their agents) can only exacerbate this problem.

Given that this is a residential area, the proposed 'operating hours' will mean that there will be a certain amount of 'light pollution' adding to that emitted by the new style street lighting. Once the premises are fitted out, no doubt including white light L.E.D.'s and/or fluorescent lights, this will give a problem to residences opposite, some of which may well include children trying to sleep!

We trust that due consideration will be given to this epistle, when the merits-or otherwise- are considered by the Council.

We remain'

Yours Faithfully,  
Andrew & Vivienne Smith  
55 York Road,  
Windsor.  
SL4 3PA

## Licensing

---

**From:** Larry Quirke [REDACTED]  
**Sent:** 10 December 2018 19:01  
**To:** Licensing  
**Cc:** Cllr Quick  
**Subject:** Re: Costcutter Springfield Road

Caution: External email. Think before clicking links or opening attachments.

Dear RBWM licencing Department,

Wish to raise an objection to the licencing application ref 200140 for 113-117 Springfield Road, Windsor, SL4 3PZ.

My reasons are:

- 1, There is already a facility in Springfield road that provides a service to the local community.
- 2, Opening hours of 7am to 11pm will disturb many of the residence who are elderly.
- 3, Deliveries will only compound the existing traffic problems.

Please can acknowledge receipt of this e mail by return?

Kind regards,

Larry Quirke.  
125 Springfield Rd.  
Windsor Berkshire.  
SL4 3PZ.

## **Katia Russo**

---

**From:** Cllr Quick  
**Sent:** 14 November 2018 15:29  
**To:** Cllr Bowden; Katia Russo  
**Subject:** Re: Objection letter for application for Off-Licence for 113-117 Springfield Road

Dear Katia

I like Cllr. Bowden have been contacted by objectors regarding the application for a licence to sell alcohol from 113-117 Springfield Road. Apart from a stationer and a licensed convenience store the road and surrounding roads are exclusively quiet residential houses and bungalows.

The existing shop closes at 8.00pm so there is no disturbance or nuisance caused in the evenings. If a new establishment is granted permission to sell alcohol as off sales until 11.00pm it will create noise and potentially anti-social behaviour spilling out onto the neighbouring grass area right under resident's windows. It will change the nature of the area.

I strongly agree with Cllr. Bowden's request for this to come to panel unless officers have already decided to refuse the application.

Kind Regards

Cllr. Quick  
Clewer East



**Katia Russo**

---

**From:** Cllr Bowden  
**Sent:** 13 November 2018 23:53  
**To:** Katia Russo; Cllr Quick  
**Subject:** Fwd: Objection letter for application for Off-Licence for 113-117 Springfield Road

Dear Katia

Below is a letter received from the licensed premises - within 10 metres of the application in Springfield Road.

I received a telephone call from the objector who had been approached by a number of residents expressing their concern over the application.

The objector is self policing their own sales through knowledge of families and residents over a number of years.

The new applicant will be unable to do this.

I support her objection, and this application should go to the licensing panel. I am a member of this panel, but I will absent myself and speak on behalf of the applicant and the concerned residents.

Regards

Cllr John Bowden  
Clewer East  
07905906957

Sent from my iPad

W. Quirk

Steve Smith

Pam  
109 Springfield Road  
Windsor  
SL4 3PZ

### Petition from Springfield Road and surrounding area

Objection to the proposed off-licence and supermarket at 113-117 Springfield road, Windsor, SL4 3PZ

We object to proposed off-licence and supermarket as this would cause the following issues:

- 1. Crime and disorder** - The proposed opening hours of the off-Licence from 6.00 am to 11.00 pm shows lack of awareness of the local area and a lack of responsibility to the community. With the potential increase in crime with the additional availability of Alcohol until late.
- 2. The prevention of public nuisance** - The availability of alcohol to purchase for longer hours would potentially encourage youngsters to hang around on the benches nearby the area until late and misbehave in an anti-social behaviour.
- 3. The protection of children from harm** - Increase in traffic due to delivery Lorries, parking problems for residence and school would present a danger to the local children and the children attending local school.
- 4. No Requirement** - There is no requirement for another shop with an alcohol licence on a parade of just three commercial properties, it would be far more beneficial to provide the diversity of another trade that locals residents and next door school can benefit from

If you agree with these Points please sign the petition below

Thank you

Name	Address	Signature	Date
B. URDIN	8 PEEK CLOSE	BG Urdin	21-11-18
S. Smau	Westmead	Smau	21/11/18
A meakes	Princess Av	A meakes	21-11-18
E Boyle	34 PEEK CLOSE	E Boyle	21-11-18
J. KILBRAY	27 Berkeley Avenue	J Kilbray	21-11-18
C. Kelly	6 Westmead	C Kelly	21/11/18
P HAIG	79 Springfield Rd	P Haig	21/11/18
C. Tomasso	5 Upcroft	C Tomasso	21/11/18
T. Dancy	128 Springfield Rd	T Dancy	21/11/18
J. Boyle	109 Springfield Rd	J Boyle	21/11/18
S. G. Jones	122 Springfield Rd	S. G. Jones	21/11/18
M REDMOND	4 SPRINGFIELD RD	M Redmond	21-11-18
D. Baker	2 DUNSON CLOSE	D Baker	21 11 18
M. Dangerfield	2 ALMOND CLOSE	M Dangerfield	21 11 18

Name	Address	Signature	Date
J. Hamlin	104 Springfield Rd	J. Hamlin	21.11.18
Brian King	32 Plover Road	B King	21.11.18
Dawn Curran	136 Springfield Rd	D Curran	21.11.18
Arie Harkin	2 WESTMEAD	AH	21/11/18
JAKE Arnold	2 WESTMEAD RD	JA	21.11.18
Peggy Outwater	2 York Avenue	PAO	21.11.18
CLIVE HOLLAND	108 SPRINGFIELD ROAD	C.F. Holland	21.11.18
Sam Jones	33 Victor Road	S Jones	21.11.18
Jane King	17 Berkeley	JK	21.11.18
Man Bell	7 Riverway	MB	21/11/18
Je Berr	44 York Rd.	JB	21.11.18
J. Hole	64 Berkeley Ave	J Hole	"
J. Berr	1A SPRINGFIELD RD	J Berr	21.11.18
E Mealen	85 Bolton Rd	EM	21.11.18
D. Coumbe	31 Upcroft	DC	21.11.18
P. HEGGE	2 CEDAR COURT, BRCHINGDON	P. Hegge	21/11/18
I mull	32A WESTMEAD	I mull	21/11/18
K. Dorrett	10 Clewer ave	K Dorrett	21/11/18
J JARROLD	2 DYSON CV	J Jarrold	21.11.18
L WRIGHT	34 UP CROFT	L Wright	21.11.18
E. SHARKE	36 SPRINGFIELD	E Sharke	21/11/18
R McEvoy	134 Springfield Rd	R McEvoy	21.11.18
S. Redmond	46 York Road	S. Redmond	21/11/18
M. Berr	8 York Rd	M Berr	21/11/18

Name	Address	Signature	Date
Jaiga Kaluini	56 York Road		21.11.18.
JENNIFER McGRATH	16 ARBANT RD		21.11.18
Chelsea Harris	1 Westmead		21/11/18
KAREN PAGE	14 VISCOUNT COURT VANSITTART	K page	21-11-18
CBrown	50 WILKINSON ST 5243PG		21.11.18
A. Pires	144 VALLEYS ONKIND SCHOOL		21/11/18
BE JONES	54 DUNCROFT WINDSOR		21/11/18
Laura Murray	87 Fernight Place		21/11/18
Lisa Fitzgerald	6 Aragon Court Windsor		21/11/18.
A Evans	33 Clifton Rd	A Evans	21/11/18
A BROOKLYN	17 NELSON PI		21/11/18
A Grazzi	Cones Close		21/11/18
Ben Watkins	366 Upcroft		21/11/18
John Cooper	47 Bulkeley		21/11/18
CHRISTOPHE DE FALOEIA	37 SPRINGFIELD RD		21/11/18
Awen Spink	98 Springfield RD		21/11/18
Viviane Callaway	22 PEEL CLOSE		21/11/18
Clare Adams	Spencer Rd		21/11/18
Poste Menard	Westmead		21/11/18
Anna Martini	Bulkeley Avenue	Ann Martini	21/11/18
Shom	Peel Close		21/11/18
M. B. G.	Springfield Rd		21/11/18.
L. Moran	11 Springfield	L Moran	21/11/18
B. S. G.	126 Springfield Rd		23.11.18

Name	Address	Signature	Date
April	24 Clewer Avenue	April	21/11/18
Mauseen	30 Peel Close	M. Dea	21/11/18
Dunbar	47 York Road	Dunbar	21/11/18
J. Creaney	51 Ballycreevy	J. Creaney	21-11-18
Merida	9 Peel Close	Merida	21.11.18
M. Davis	8 W. M. ERK	M. Davis	21.11.18
Michael Morris	42 Park Hill, Windsor SL4 5GE	Michael Morris	21/11/18
Emma Featerra	2 Broadwell SL4 4NR	Emma Featerra	21/11/18
MARIN TAYLOR	41, PEEL CLOSE	M. Taylor	21/11/18
Sel Huskins	21 Kings Rd	Sel Huskins	21/11/18
A. Shorice	14 Green Lane	A. Shorice	21/11/18
Michael Cech	The Lawns Nursery	Michael Cech	21/11/18
Karen Lane	19 Gosmore SL4 5HT	K. Lane	21/11/18
Kelly St Claire	12 Woodland Ave, SL4 4AC	K. St Claire	21/11/18
Lesley Godfrey	67 Princess Ave SL4 3LX	L. Godfrey	21.11.18
Debbie Pule	13 Sycamore Ct.	Debbie Pule	22.11.18
G. Hayes	10 Upcroft	G. Hayes	21-11-18
Emma B	8a Westmead	E. B.	21.11.18
Joe NM	8A WESTMEAD	Joe NM	21.11.18
L. Dudley	12A Westmead	L. Dudley	21.11.18
P. Flynn	39 Elm Road	P. Flynn	21/11/18
Wagne Babo	32 Westmead	Wagne Babo	21/11/18
Maggie Bale	Oakfield Sch	M. Bale	21/11/18
Loretta O'Connell	OAKFIELD SCH	L. O'Connell	21.11.18

Name	Address	Signature	Date
Amhaud Hallett	12 Springfield Close		21/11/18
M. Lethington	13 Martin Close, Windsor		21/11/18
Newsday Kennealy	33 Westmead		21/11/18
Giles Kay	Springfield Rd		22/11/18
Olivia Kay	Springfield Rd		22/11/18
James Kay	Springfield Rd		22/11/18
Roy Frost	Springfield Close		22/11/18
Amy Caplin	33 Clewes Newtown		22/11/18
H.S. Bowdman	110 Springfield Road		22/11/18
Ken Jones	18 Oak Trees Ash		23/11/18
Robert Koca	5 Cedar Court		23/11/18
Andrew Smith	12 of 33, Wil. Leeve's W.R.B.		23/11/18
NELME GUY	Stamonds House 3rd		23/11/18
J. GRAY	PRINCESS AV 52		24/11/18
GRAHAM Young	69 BULLOCKLEY AVE.		24/11/18
A. M. WELLS	24 CEDAR COURT BRACKENHURD		24/11/18
M. Davis	4a Westmead		24/11/18
A. Fisher	52 Springfield Rd		25/11/18
E. Quirk	45, York Road		25/11/18
e. w. w. w. w.	Windsor Ave. J		26/11/18
A. WARREN	25 College Cres		29/11/18
A. HARKNESS	57 BULLOCKLEY AVE		30/11/18
Jatinder Singh	6 Fuldaff Road		30/11/18
Tom Quirk	4-5 York Road		4/12/18

Name	Address	Signature	Date
J Manger	127 Springfield Rd	J Manger	1/12/18
B. Wells	Swindon Close	B. Wells	1/12/18
J P Sleepers	5 Down Lane	J P Sleepers	5/12/18
REID OFFICE SUPPLIES	107 SPRINGFIELD RD	J Reid	10/12/18
Ang Cercia	263 DEDWORTH RD	Ang Cercia	10/12/18
G. Payne-Allen	33 ALMA RD	G. Payne-Allen	10/12/18
J SPINK	5 Springfield Close	J SPINK	10/12/18
N. Clark	17 Springfield Road	N. Clark	10/12/18
M Hall	Pipers, Hatch Lane,	M Hall	10/12/18
The Alma Public House	61 Springfield Road	M Hall	10/12/18
Starc Motors	2 Elm Road	[Signature]	10/12/18
TOP SHOP.	28 St Leonards Rd.	[Signature]	10/12/18
Growth stores	452 St Leonards Rd.	[Signature]	10/12/18
Ravi Express Food	125 Winsor	R. Singh	10/12-18
ALAN STORE	29 SINSOR	[Signature]	10/12/18
JESSICA SHOP	SLY SAN 29 CLERACE ROAD	[Signature]	10/12/18
Z BIERNAT	1 Lombard Close SLY SPY	Z Biernat	10/12/18
B. JAMES	2 Causeway Close SLY SPY	B. James	10/12/18
P. JAMES	"	P. James	"
Leha	Alma Road	Leha	10/12/18
P. Owen	Elm Road	[Signature]	10/12/18
S Birdman	York Ave	[Signature]	10/12/18
J. Dennison	MANTLE Close	[Signature]	10/12/18
M GIBBONS	6 Villages Ct Windsor	[Signature]	10/12/18

## Petition from Springfield Road and surrounding area





**Objection to the proposed off-licence and supermarket at 113-117 Springfield road, Windsor, SL4 3PZ**

We object to proposed off – licence and supermarket as this would cause the following issues:

1. **Crime and disorder** - The proposed opening hours of the off-Licence from 6.00 am to 11.00 pm shows lack of awareness of the local area and a lack of responsibility to the community. With the potential increase in crime with the additional availability of Alcohol until late.
2. **The prevention of public nuisance** - The availability of alcohol to purchase for longer hours would potentially encourage youngsters to hang around on the benches nearby the area until late and misbehave in an anti-social behaviour.
3. **The protection of children from harm** - Increase in traffic due to delivery Lorries, parking problems for residence and school would present a danger to the local children and the children attending local school.
4. **No Requirement** - There is no requirement for another shop with an alcohol licence on a parade of just three commercial properties, it would be far more beneficial to provide the diversity of another trade that locals residents and next door school can benefit from

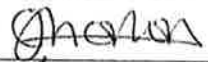
If you agree with these Points please sign the petition below

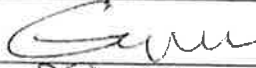
Thank you

Name	Address	Signature	Date
Mrs Emma Horton	15 DYSON CLOSE		11-12-18
KOREGAN	97 SPRINGFIELD SL4 3PR		11-12-18
Mrs E Curjume	6 Springfield Close		11-12-18
P. GATER	23 WESTMEAD		11/12/18



**PREMISES LOCATION**

